



tel: 252-431-1208
 tel: 800-293-1004
 fax: 252-430-0025
 web site: www.salareinc.com
 E-mail: sales@salareinc.com



FCR-SERIES All Polypropylene DUCTLESS HOOD

(Counter-Top, Base Cabinet or Base Stand Configuration)

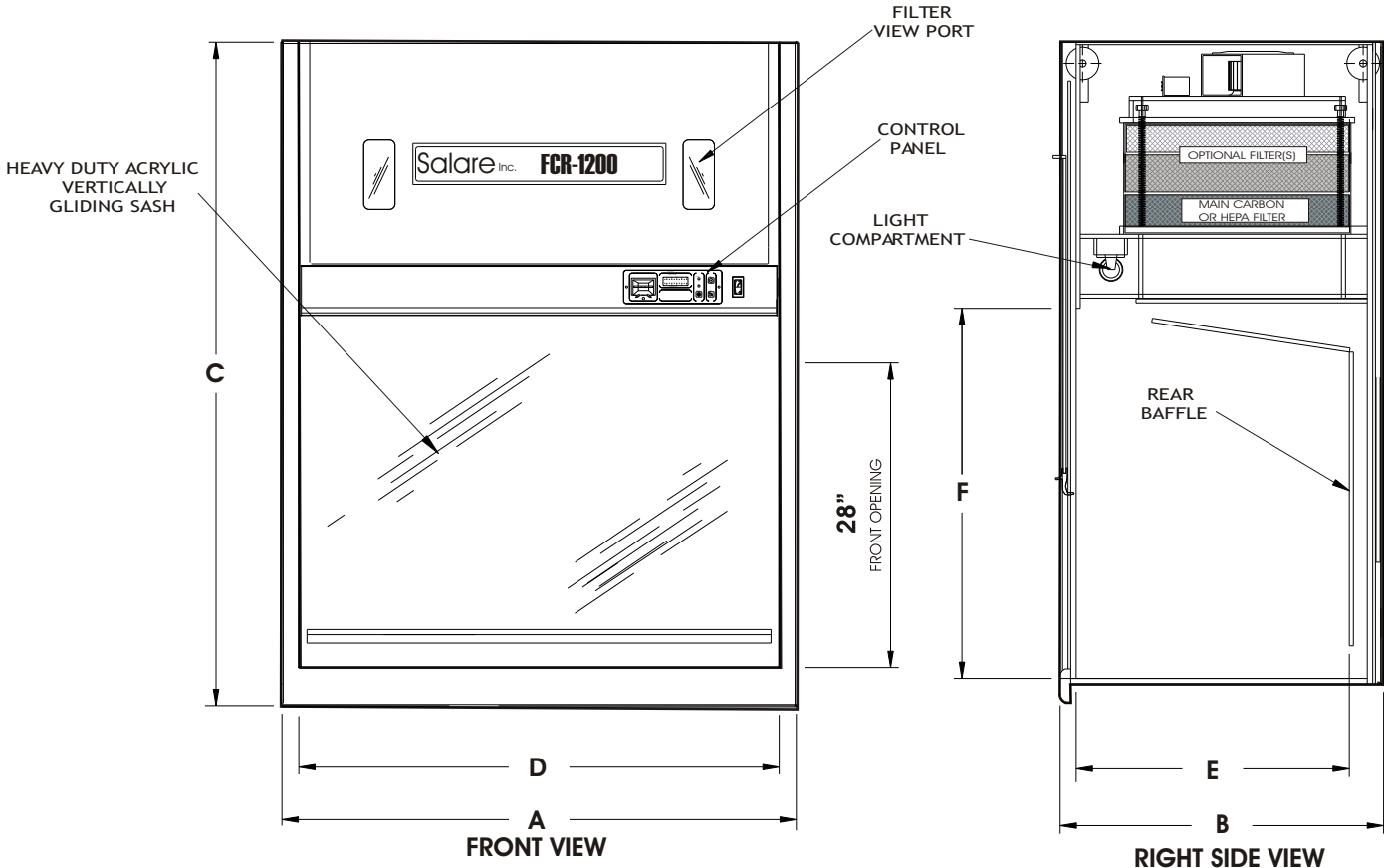

Also available in custom sizes

PERTINENT DATA

MODEL NUMBER	Width (A)	Depth (B)	Height (C)	Internal Width (D)	Internal Depth (E)	Internal Height (F)	HEPA and/or CARBON FILTERS	Min. # filter(s) unit Accommodates	Max. # filter(s) unit Accommodates	Number of Fans
FCR-1000 (Nominal 3')	39.4" 1000mm	29.75" 755mm	59" 1500mm	38.4" 975mm	25.6" 650mm	33.4" 848mm	HEPA and/or CARBON FILTERS	(1) size "B"	(3) size "B"	1
FCR-1200 (Nominal 4')	47.2" 1200mm	↓	↓	46.2" 1173mm	↓	↓		(2) size "B"	(6) size "B"	2
FCR-1500 (Nominal 5')	59.2" 1500mm	↓	↓	58.2" 1478mm	↓	↓		(2) size "B"	(6) size "B"	2
FCR-1800 (Nominal 6')	71" 1800mm	↓	↓	70" 1778mm	↓	↓		(3) size "B"	(9) size "B"	3

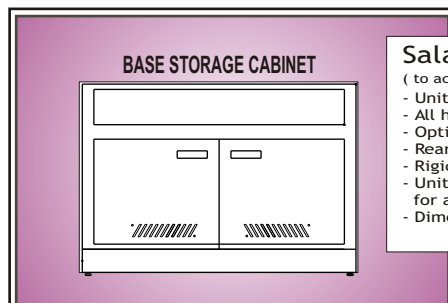

Salare's PBC-Series Base Cabinets

(to accommodate Salare FCR Series Fume Hoods)

- Unit constructed from white stress relieved, non-corrosive polypropylene.
- All heat seam welded and tested.
- Optional, recess service panel just below work top.
- Rear bulkhead recessed 6" for services with access panel.
- Rigid polypropylene base with levelers.
- Units have hinged doors with all plastic hardware and adequate storage for acids or reagents
- Dimensions to be width of work station x 34" high x 29.75" deep